

BV-TNG

DIN 24960

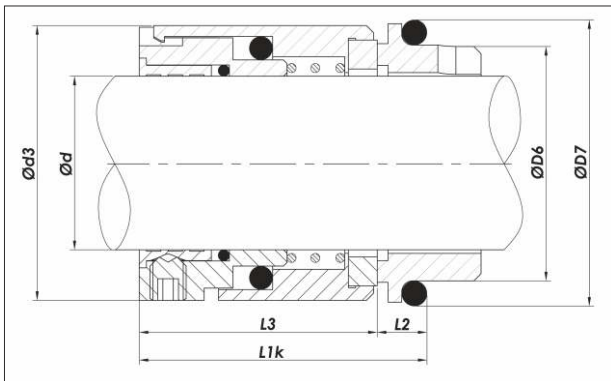

- (A,)
- (U₃)
- (Q₁, Q₂)
- Al₂O₃ (V)
- , FKM (V)
- (P)
- , EPDM (E)
- , FFKM (Kalrez®)
- FEP

- p = 40
- t = -50 ... 220°C
- v = 20 /

DIN 24960 (EN12756)

d	d ₃	D ₆	D ₇	L _{1k}	L ₂	L ₃
14	24.0	21	25	38.0	5.5	32.5
16	26.0	23	27	40.0	5.5	34.5
18	32.0	27	33	37.5	7.0	30.5
20	34.0	29	35	37.5	7.0	30.5
24	38.0	33	39	40.0	7.0	33.0
25	39.0	34	40	40.0	7.0	33.0
28	42.0	37	43	42.5	7.0	35.5
30	44.0	39	45	42.5	7.0	35.5
32	47.0	42	48	42.5	7.0	35.5
33	47.0	42	48	42.5	7.0	35.5
35	49.0	44	50	42.5	7.0	35.5
38	54.0	49	56	45.0	8.0	37.0
40	56.0	51	58	45.0	8.0	37.0
43	59.0	54	61	45.0	8.0	37.0
44	61.0	56	63	45.0	8.0	37.0
50	66.0	62	70	47.5	9.5	38.0
53	68.5	65	73	47.5	9.5	38.0
60	80.0	72	80	52.5	10.5	42.0
65	85.0	77	85	52.5	10.5	42.0
70	90.0	83	92	60.0	11.5	48.5
75	99.0	88	97	60.0	11.5	48.5
80	104.0	95	105	60.0	11.5	48.5
95	119.0	110	120	65.0	13.0	52.0
100	124.0	115	125	65.0	13.0	52.0

+

