

NMM-1

DIN 24960 (EN12756)

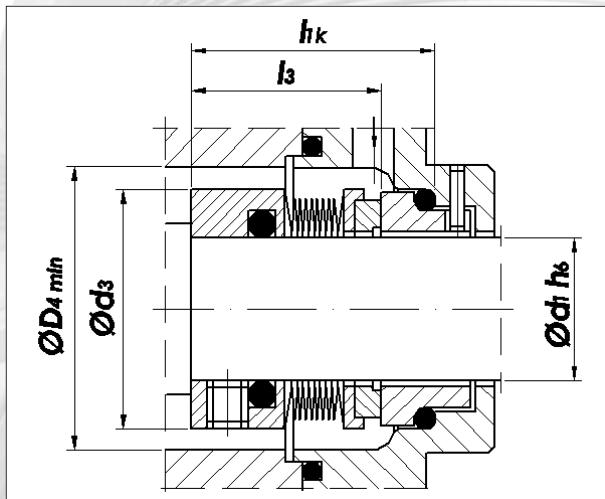

NMM-G

DIN 24960

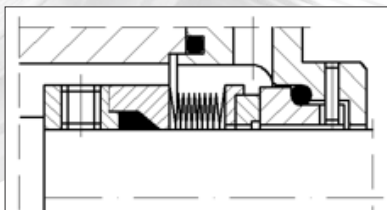

- $p = 15$
- $t = -50 \dots 220^\circ\text{C}$ (NMM-1)
- $t = -20 \dots 350^\circ\text{C}$ (NMM-G)
- $v = 25$ /

NMM-1/SC/



- (A,)
- (U₃)
- (Q₁, Q₂)
- , FKM (V)
- (P)
- , EPDM (E)
- (G)

| d_1 | d_3 | D_{4min} | l_3 | l_k |
|-------|-------|------------|-------|-------|
| 20 | 34 | 36 | 25.5 | 37.5 |
| 22 | 36 | 38 | 25.5 | 37.5 |
| 24 | 38 | 40 | 28 | 40 |
| 25 | 39 | 41 | 28 | 40 |
| 28 | 42 | 44 | 30.5 | 42.5 |
| 30 | 44 | 46 | 30.5 | 42.5 |
| 32 | 46 | 48 | 30.5 | 42.5 |
| 33 | 47 | 49 | 30.5 | 42.5 |
| 35 | 49 | 51 | 30.5 | 42.5 |
| 38 | 52.5 | 56 | 32 | 45 |
| 40 | 54.5 | 58 | 32 | 45 |
| 43 | 58 | 62 | 32 | 45 |
| 45 | 60 | 64 | 32 | 45 |
| 48 | 63 | 67 | 32 | 45 |
| 50 | 66 | 70 | 34 | 47.5 |
| 53 | 69 | 73 | 34 | 47.5 |
| 55 | 71 | 75 | 34 | 47.5 |
| 58 | 74 | 78 | 39 | 52.5 |
| 60 | 76.5 | 80 | 39 | 52.5 |
| 63 | 79.5 | 84 | 39 | 52.5 |
| 65 | 81.5 | 85 | 39 | 52.5 |
| 68 | 85 | 89 | 39 | 52.5 |
| 70 | 88 | 92 | 45.5 | 60 |
| 75 | 93.5 | 98 | 45.5 | 60 |
| 80 | 98.5 | 103 | 45 | 60 |
| 85 | 105 | 110 | 45 | 60 |
| 90 | 110 | 115 | 50 | 65 |
| 95 | 115 | 120 | 50 | 65 |
| 100 | 120 | 125 | 50 | 65 |

+